

R-Control SIP  
used as header.

8d box (0.113)  
nails @ 6" o.c. each  
side, top & bottom  
or equivalent.

R-Control Do-All-Ply  
1/2" diameter  
continuous bead.

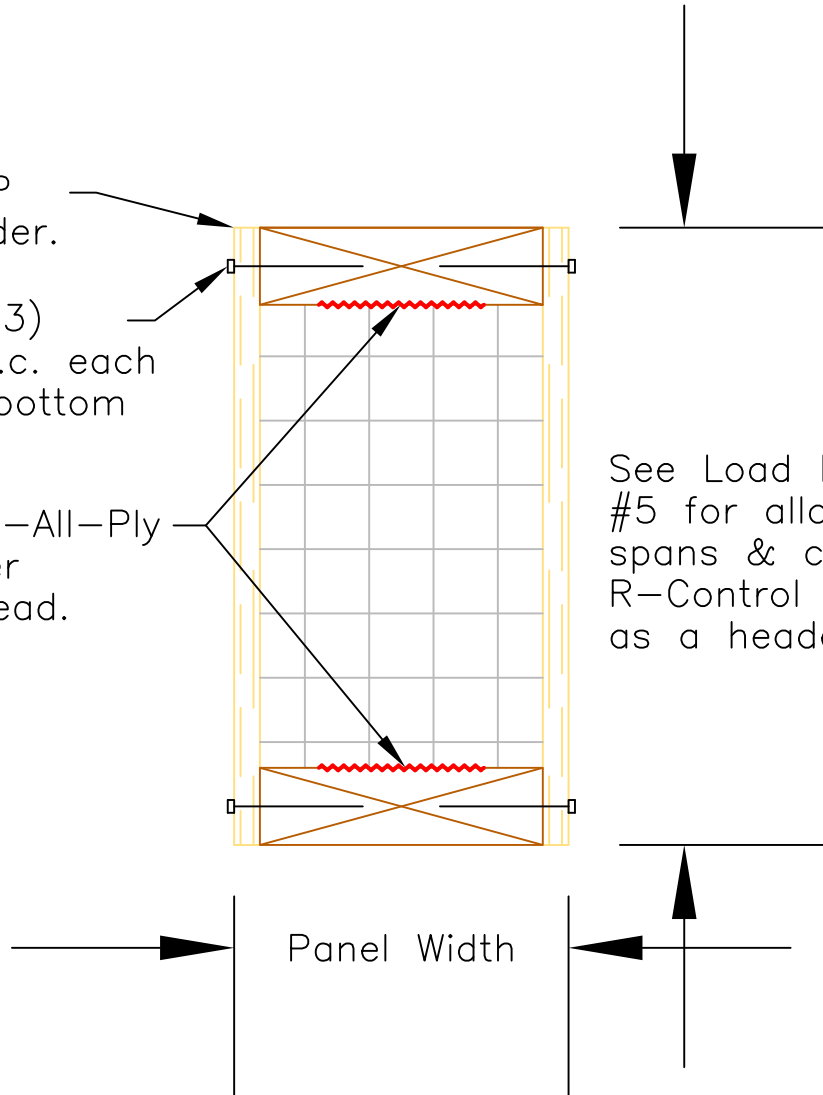

See Load Design Chart  
#5 for allowable depths,  
spans & capacities of  
R-Control SIP used  
as a header.

## SECTION

Scale: NTS

Updated 1-16-12

R-Control® SIP

TITLE:

SIP Header Plates

NO.

SIP-113